

# RAM-B-342U INSTALLATION INSTRUCTIONS

## PARTS LIST

- A- 1 QTY. RAM STEM BASE CASTING WITH 1" DIA. BALL
- B- 1 QTY. RUBBER EXPANSION PLUG
- C- 1 QTY. EACH 5mm ID X 12mm, 14mm, 16mm, 18mm, 20mm, 28mm OD STST FLAT WASHERS
- D- 1 QTY. 5mm BRASS NYLOCK NUT
- E- 1 QTY. 5mm X 60mm LONG FLAT HEAD STST MACHINE SCREW
- F- 1 QTY. WASHER SET WITH NUT POCKET AND GRIPPER TEETH (SET OF 6 SIZES)

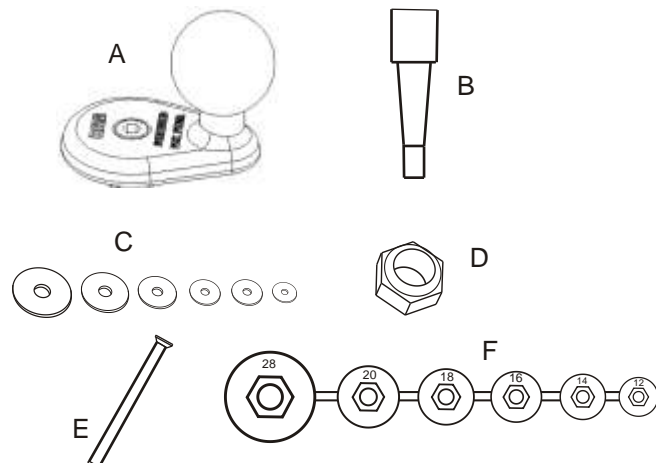

## STEP 1

INSERT EXPANSION PLUG (PART B) INTO MOTORCYCLE STEM HOLE, PRESS DOWN UNTIL SNUG.

- MARK POINT ON PART B WHERE IT MEETS AT STEM HOLE OPENING (TOP MARK)
- REMOVE AND CUT PART B AT TOP MARK
- MEASURE 1" DOWN (TOWARD SMALLER DIAMETER) FROM TOP MARK AND CUT BOTTOM OF EXPANSION PLUG  
(DIAGRAM REFERENCES ARE EXAMPLE MARKS ONLY, INDIVIDUAL MEASUREMENTS WILL VARY)

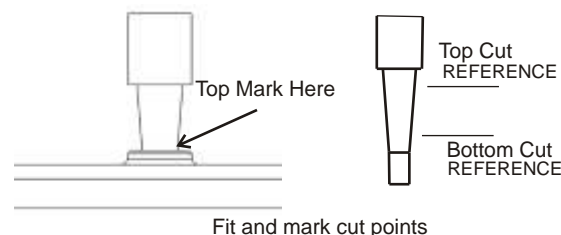

## STEP 2

ASSEMBLE RAM-B-342U AS SHOWN USING LARGEST STST FLAT WASHER (C) AND WASHER WITH NUT POCKET & GRIPPER TEETH (F) THAT WILL FIT IN THE STEM HOLE. TIGHTEN ASSEMBLY ENOUGH TO HOLD TOGETHER. (DO NOT INSTALL IN STEM HOLE FOR THIS PROCESS).

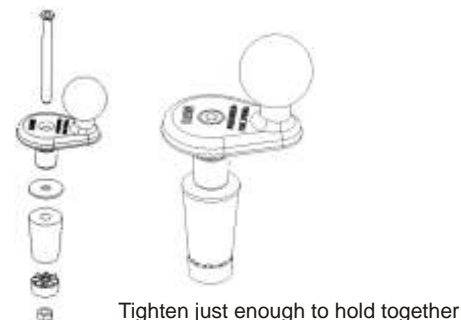

## STEP 3

PRIOR TO INSTALLING STEM BASE ASSEMBLY IN STEM HOLE, PRE-TIGHTEN SCREW ASSEMBLY TO EXPAND RUBBER PLUG SO THAT IT IS A SNUG FIT WHEN PRESSED IN THE STEM HOLE. (THIS WILL HELP HOLD NUT FROM TURNING). PLACE ASSEMBLY INTO STEM HOLE AND POSITION IT.

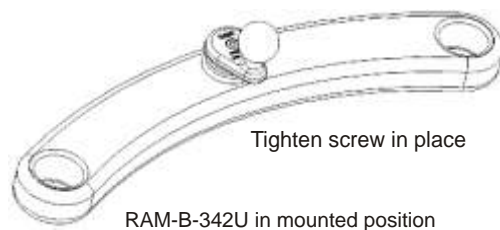

## STEP 4.

TIGHTEN MACHINE SCREW WITH ALLEN WRENCH (NOT SUPPLIED). ONCE TIGHT, ROTATE ENTIRE ASSEMBLY CLOCKWISE TO TIGHTEN EVEN FURTHER.

