



# AX1783

## Xtrem skid plate

### Triumph TF250-X / TF250-E

#### What's in the box ?

- 1 PM03-04-137 - Rear alloy fixation
- 1 PM01-10-035 - Rear plastic block 30mm
- 1 PM01-04-287 - Front plastic fixation
- 1 NE04-01-295 - Big sticker
- 1 NE04-01-293 - Small sticker
- 1 PM01-06-095 - Rear plate n°57
- 2 NE01-06-003 - TH 6x30mm screws
- 2 NE10-01-004 - Shouldered rings
- 2 NE01-04-002 - Clamped bolts
- 2 NE01-01-009 - TBHC 6x20mm screws
- 2 NE01-03-006 - M6 large washers
- 6 NE01-03-001 - M6 washers
- 6 NE01-04-003 - EM6F bolts
- 1 NE01-02-003 - TFHC 6x25mm screw
- 1 NE01-02-004 - TFHC 6x30mm screw
- 4 NE01-02-002 - TFHC 6x20mm screws



The paper instructions may be limitless, scan the QR code to watch the tutorial video online.



# Assembling instructions

Approximate time of assembly: 15 minutes.

A skid plate is made to protect the vital components of your bike and does not have a « life warranty ». However, production default may happen and we cover it during the first year of use.

In case of premature breakage, please write to [contact@axpracing.com](mailto:contact@axpracing.com)

## Follow the steps

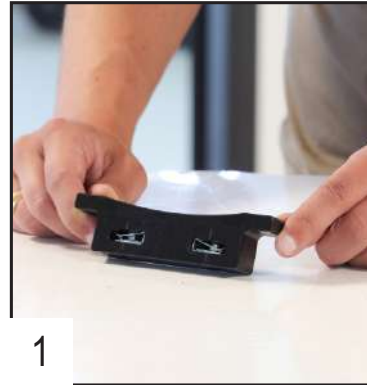

Insert the clamped bolts in the front fixation.

Insérez les écrous-pinces dans la fixation avant.

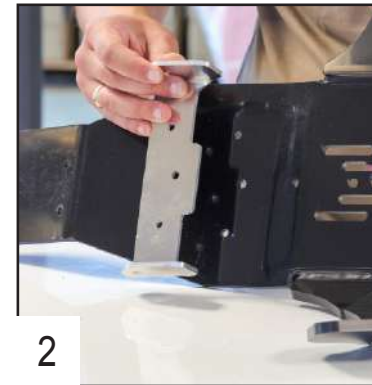

Place the rear fixation in aluminum on the rear of the plate. Make sure to align the three holes correctly.

Placez la fixation en alu à l'arrière en alignant les 3 trous.

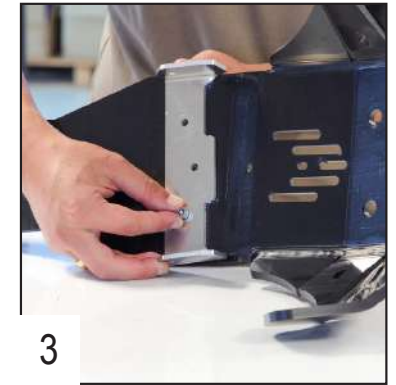

Use 2 TFHC 6x20mm screws + M6 washers and bolts to fix the aluminum part without tightening.

Utilisez 2 TFHC 6x20mm + rondelles et écrous sans serrer les vis.

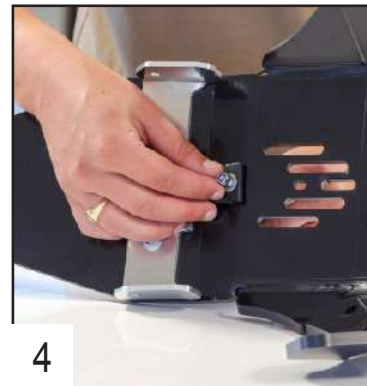

Place the plastic fixation on top of the aluminum part. Use a TFHC 6x25mm screw on the front and a TFHC 6x30mm at the rear.

Placez la fixation en plastique sur celle en alu. Utilisez une TFHC 6x25 à l'avant et une TFHC 6x30 à l'arrière.

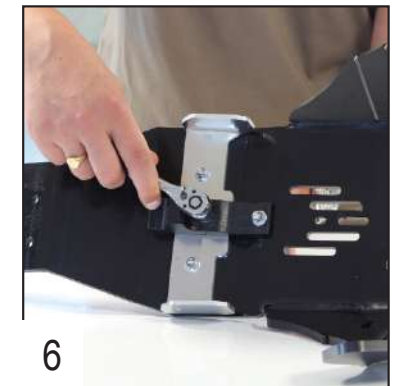
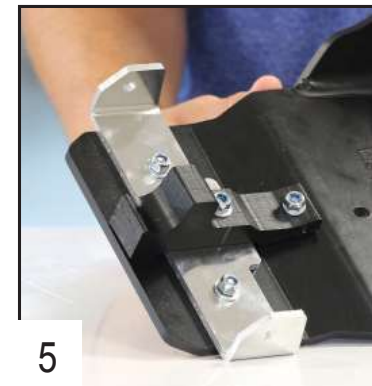

Tighten all four screws.

Serrez les 4 vis.



7

Put the linkage guard plate in place.

Placez la plaquette sur la partie arrière.



8

Use 2 TFHC 6x20mm screws + M6 washers and bolts to fix the plate.

Utilisez 2 TFHC 6x20mm + M6 rondelles et écrous pour fixer la plaquette sur le sabot.

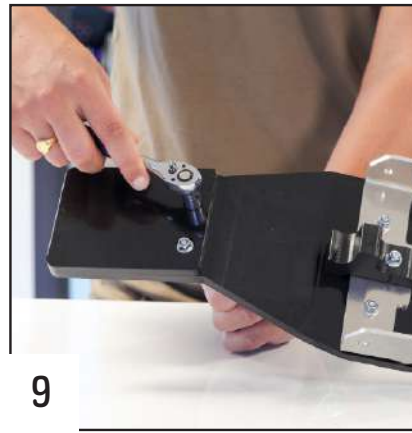

9

Tighten the screws.

Serrez les deux vis.



10

Place the front fixation between the frame rails.

Placez la fixation avant entre les tubes du cadre.



11

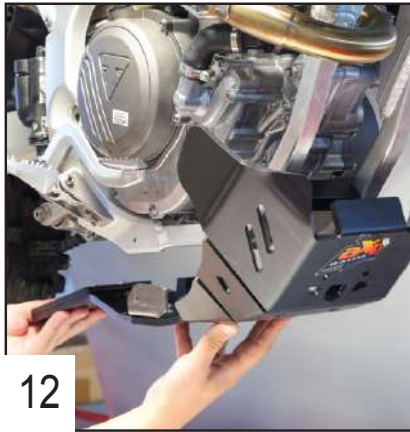

12

Place the skid plate under the bike.

Placez le sabot en dessous de la moto.



13

Use a TBHC 6x20mm screws + large M6 washer to fix the plate on each side of the bike. Do not tighten.

Utilisez une TBHC 6x20mm + grande rondelle M6 pour fixer le sabot de chaque côté de la moto, sans serrer les vis.



14

Place 2 TH 6x30mm screws and 2 shouldered rings in the front holes. Do not tighten.

Placez 2 entretoises et 2 TH 6x30mm à l'avant, sans serrer les vis.



15

Tighten the rear screws.

Serrez les vis à l'arrière.

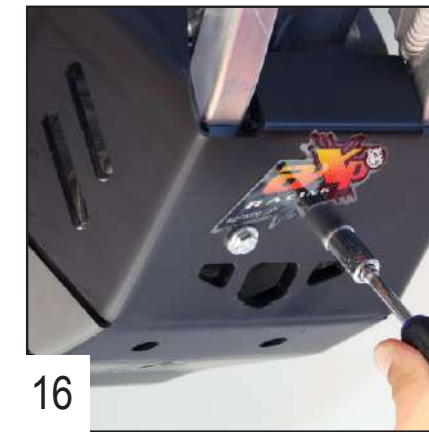

16

Tighten the front screws.

Serrez les vis à l'avant.

**You're all ready to ride !**