



AX1810

Chain guide

Suzuki DR-Z4S

Assembling instructions

What's in the box ?

- 2 NE01-02-013 - TFHC 6x60mm screws
- 2 NE01-06-004 - TH 6x60mm screws
- 1 NE01-06-010 - TH 6x15mm screws
- 4 NE01-03-001 - EM6F bolts
- 2 NE01-04-003 - M6 washers
- 5 NE10-01-004 - Shouldered alloy ring



The paper instructions may be limited, scan the QR code to watch the tutorial video online.

Approximate time of assembly: 15 minutes



Chain guards are made to protect the vital components of your bike and does not have a «life warranty». If you notice a defect on your chain guards at reception, please write to contact@axpracing.com

Off-road riding involves significant stresses and risks of impact on the motorcycle and its components. AXP Racing products are designed to improve protection and durability; however, they cannot be considered a foolproof guarantee against damage. AXP Racing accepts no liability for damage resulting from use, impact, or misuse.

Follow the steps



1

Place 2 alloy rings in the outside holes of the smallest part.

Placez 2 entretoises sur l'extérieur de la petite partie.

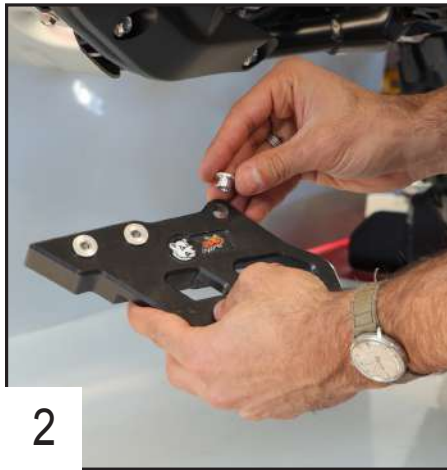

2

Place 3 alloy rings on the outside of the biggest part.

Placez 3 entretoises à l'extérieur de la grande partie.

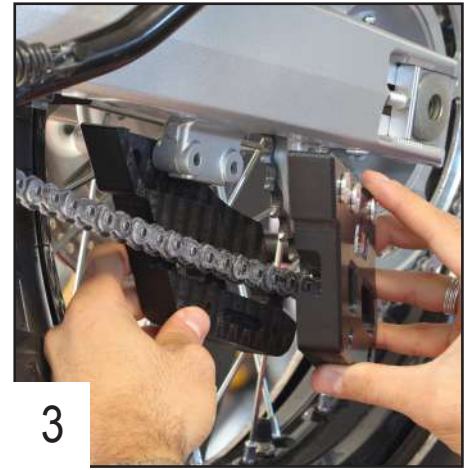

3

Clip the 2 parts on each side of the chain.

Clipsez les 2 parties de chaque côté de la chaîne.

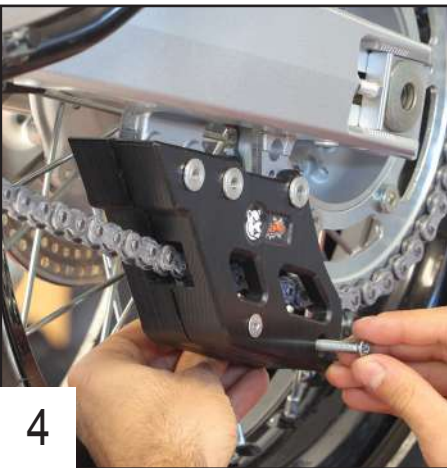

4

Place 2 TFHC 6x60mm screws + M6 washers and bolts in the bottom screws.

Placez 2 vis + rondelles et écrous dans les trous inférieurs.

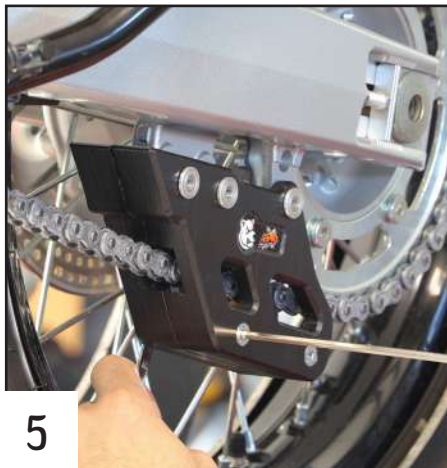

5

Tighten the screws.

Serrez les 2 vis.

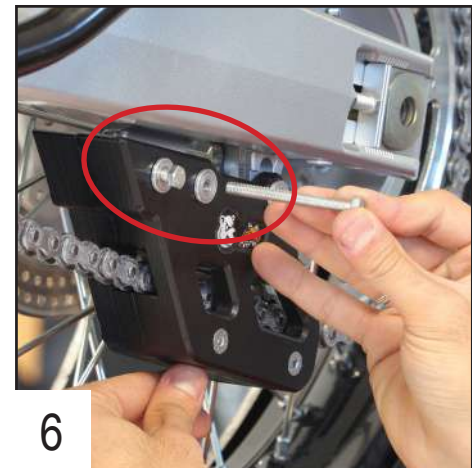

6

Place 2 TH 6x60mm screws + M6 washers and bolts in the 2 front holes.

Placez 2 vis + rondelles et écrous dans les trous à l'avant.



7

Place one TH 6x15mm screw in the top rear hole.

Placez une vis dans le trou supérieur arrière.

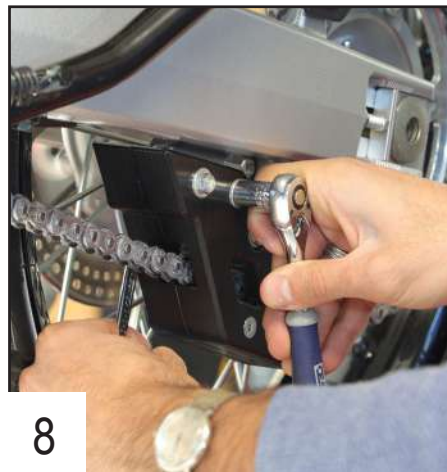

8

Tighten the front screws.

Serrez les deux vis à l'avant.

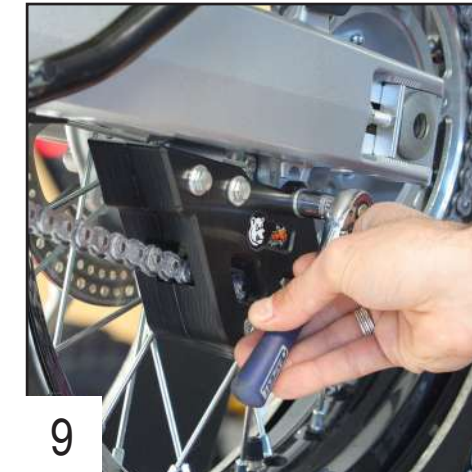

9

Tighten the rear screw.

Serrez la vis à l'arrière.

You're all ready to ride !