



**Référence:** E13\*81R00/02\*9809\*01

**Annexes:** - Rapport Technique  
- Fiche de Renseignements du constructeur

Luxembourg, le 15 juillet 2019



**Communication concernant:** - **DELIVRANCE D'UNE HOMOLOGATION**  
Communication concerning: APPROVAL GRANTED  
- **EXTENSION D'HOMOLOGATION**  
APPROVAL EXTENDED  
- **REFUS D'HOMOLOGATION**  
APPROVAL REFUSED  
- **RETRAIT D'HOMOLOGATION**  
APPROVAL WITHDRAWN  
- **ARRET DEFINITIF DE LA PRODUCTION**  
PRODUCTION DEFINITELY DISCONTINUED

**d'un type de rétroviseur, conformément au Règlement N° 81**  
of a type of rear-view mirror pursuant to Regulation N° 81

**Numéro d'homologation:**

Approval number:

E13\*81R00/02\*9809\*01

**Marque d'homologation:**

Approval mark:

L (E13) 009809

**1. Marque de fabrique ou de commerce du dispositif:**

Trade name or mark of the equipment:

motogadget

**2. Type:**

Equipment type:

7002040

**3. Description sommaire comportant notamment les indications suivantes:**

Brief description including in particular the following information:

**3.1. Dimensions principales de la surface réfléchissante:**

Main dimensions of the reflecting surface:

max length: 128,5 mm  
max width: 81 mm

**3.2. Rayon de courbure nominal de la surface réfléchissante:**

Nominal radius of curvature of the reflecting surface:

1450 mm

**4. Nom et adresse du fabricant:**

Manufacturer's name and address:

motogadget GmbH  
Köpenicker Str. 145  
D-10997 Berlin

5. **Nom et adresse du représentant du fabricant (le cas échéant):**  
If applicable, name and address of the manufacturer's representative: not applicable
6. **Présenté à l'homologation le:**  
Equipment submitted for approval on: 08.04.2019
7. **Autorité déléguée:**  
Assigned authority: *Société Nationale de Certification et d'Homologation L-5201 Sandweiler*
- Service technique chargé des essais d'homologation:**  
Technical service responsible for conducting approval tests: Luxcontrol SA  
B.P. 349  
L-4004 Esch-sur-Alzette
8. **Date du procès-verbal délivré par ce service:**  
Date of report issued by that service: 06.06.2019
9. **Numéro du procès-verbal délivré par ce service:**  
Number of report issued by that service: LC 1289 004 19
10. **Véhicules pour lesquels le dispositif est destiné:**  
Vehicles for which the equipment is designed: two-wheeled motor vehicles
11. **L'homologation est 2/:**  
Approval is 2/: *accordée / refusée / étendue / retirée*  
*granted / refused / extended / withdrawn*
12. **Motif(s) de l'extension de l'homologation:**  
Reason(s) for extension of approval: refer to Annex A to technical report
13. **Lieu:**  
Place: Luxembourg
14. **Date:**  
Date: 15 juillet 2019
15. **Signature:**  
Signature:

Pour le Ministre de la Mobilité  
et des Travaux publics



Alain DISIVISOUR  
Conseiller

Pour la SNCH

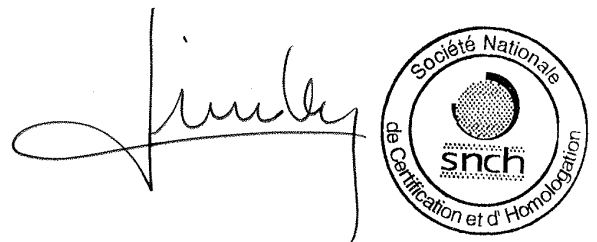

Laurent LINDEN  
Directeur opérationnel



16. **Est annexée la liste des pièces constituant le dossier d'homologation déposé au Service administratif ayant délivré l'homologation:**  
A list of documents contained in the approval file transmitted to the administrative service which has granted approval is annexed to this communication:

see index to type-approval report



**Référence:** E13\*81R00/02\*9809\*01

**Annexes:** - Rapport Technique  
- Fiche de Renseignements du constructeur

Luxembourg, le 15 juillet 2019

## Index du dossier d'homologation Index to type-approval report

	<b>Numéro d'homologation:</b> Approval number:	E13*81R00/02*9809*01
	<b>Révision:</b> Revision:	00
	<b>Marque de fabrique ou de commerce:</b> Trade name or mark:	<i>motogadget</i>
	<b>Type:</b> Type:	7002040
1.	<b>Procès-verbal d'essai:</b> Test report:	N° LC 1289 004 19
	- Technical report:	Page(s) 1 to 3;
	- Index:	Page(s) 1;
	- Communication as numbered in the standard:	Annex A - Page(s) 1;
	- Test results:	Annex B - Page(s) 1 to 3.
2.	<b>Dossier du constructeur:</b> Report of the manufacturer:	N° Annex C
	- Information document:	Page(s) <u>1 &amp; 2</u> .
3.	<b>Autres documents annexés:</b> Other documents annexed:	not applicable
4.	<b>Date de délivrance de l'homologation initiale:</b> Date of issue of initial type approval:	20.08.2018
5.	<b>Date de la dernière délivrance de pages révisées:</b> Date of last issue of revised pages:	not applicable
6.	<b>Date de la dernière délivrance d'une homologation révisée:</b> Date of last extension:	15.07.2019





## 1. General

Manufacturer: **motogadget GmbH**  
**Köpenicker Str. 145**  
**D-10997 Berlin**

~~Vehicle Type~~  
~~Or component or ESA or STU:~~ **7002040**

## 2. Test details

	Inspector	Location of test:	Date of receipt of test item:	Date of test:
Main report	D. Durazzi M. Flammang	D. Durazzi M. Flammang	July 2018	19 to 23 July 2018
		Luxcontrol s.a.	August 2018	08 August 2018
Extension 1	D. Durazzi M. Flammang	D. Durazzi M. Flammang	April 2019	08 April 2019

### 2.1. Remarks

2.1.1. Main report:

not applicable

2.1.2. Extension 1:

New tests were run to cover and validate the new versions stated in the index.



3. **Statement of compliance**

The inspections items and measurements carried out have shown the compliance of the type described in this technical report and the attached Annexes with the requirements of the standard as stated on page 1.

Esch-sur-Alzette, June 6, 2019

Luxcontrol s.a.  
Service Homologation-automobile

Max Flammang  
Ingénieur-Inspecteur

Angelo Tomasini  
Ingénieur-Inspecteur

Annexes



Details to the information package, including a summary in chronological order, concerning extensions and/or amendments

Type-approval previously granted: **E13\*81R00/02\*9809\*00**

---

### **Main Report**

Technical Report No.:	LC 1289 004 18	3 Pages
	Index	1 Page

List of Annexes:

A: Communication as numbered in the standard	1 Pages
B: Test results	3 Pages
C: Information folder	2 Pages

---

### **Extension 1**

Technical Report No.:	LC 1289 004 19	3 Pages
	Index	1 Page

List of Annexes:

A: Communication as numbered in the standard	1 Pages
B: Test results	3 Pages
C: Information folder	2 Pages

To be added:

- New versions 7004040 and 7004041

To be updated:

- Editorial arrangements

### **Content of the information folder:**

manufacturer's information document (page 1 to 2)

---



## **COMMUNICATION AS NUMBERED [] IN THE STANDARD**

- [1.] Trade name or mark:  
**motogadget**
- [2.] Type:  
**7002040**
- [3.] Brief description including in particular the following information:
- [3.1.] Main dimensions of the reflecting surface:  
**max. length: 128,5 mm**  
**max. width: 81 mm**
- [3.2.] Nominal radius of curvature:  
**1450mm**
- [4.] Name and address of the manufacturer:  
**motogadget GmbH**  
**Köpenicker Str. 145**  
**D-10997 Berlin**
- [5.] Name and address of manufacturer's authorised representative:  
**not applicable**
- [6.] Equipment submitted for type approval on:  
**8 April 2019**
- [10.] Vehicles for which the equipment is designed:  
**Two - wheel motor vehicles**
- [12] Reason(s) for extension of approval:  
**New versions 7004040 and 7004041 added.**



**1. Test results:**

**1.1. Version of the tested vehicle/item**

Following version(s) has been used for testing (if not stated in part 1.2.1. of this report):

Main report:

- 7002040

Extension 1:

- 7004040

- 7004041

**1.2. Inspection items**

**1.2.1. General specifications:**

The trade mark is engraved clearly legible and indelible on the reflecting surface.

Space for the approval marks and additional symbols is provided on the reflecting surface as shown in the information folder.

**1.2.1.1. Adjustment of the rear-view mirror**

The reflecting surface of the rear-view mirror is manually adjustable

**1.2.1.2. Rear-view mirror holder (protective housing):**

Not applicable, as the reflective surface is machined from a single part of aluminum.



1.2.1.2.1. Radius of curvature of contactable parts of the rear-view mirror:

All parts, irrespective of the adjustment position of the device, which can be in static contact with a sphere of 100 mm, have a radius of curvature of "**c**" > **2,5 mm**.

1.2.1.3. Dimensions of the reflecting surface:

The reflecting surface has an area of **more than 69 cm<sup>2</sup>**. It is possible to inscribe a circle of **min. 78 mm** on the reflecting surface.

1.2.1.4. Reflecting surface and coefficient of reflection:

Radius of curvature: **1450mm**

Coefficient of reflection: **> 40 %**

1.2.1.5. The results indicated below have been achieved by adjusting the mirror to the installation angle of:

Test (*)	Impact test results [°]		Observations
	left	right	
1	> 20°	--	no cracks / no separations
	--	> 20°	no cracks / no separations
2	> 20°	--	no cracks / no separations
	--	> 20°	no cracks / no separations

(\*) according to paragraph 8.2 and 8.4. of the Regulation

1.2.1.6. Bending test:

Not applicable for external mirrors.

**1.3. Remark**

1.3.1. General:

The inspection results are applicable to all the variants named in the manufacturer's information folder (annex C). The tested rear-view mirrors variants cover the worst cases for the different situations



**1.4.**

**Test facilities**

Calibration of measuring and test equipment used to carry out the inspections is in accordance with the ECE-Regulation stated in 1.1. of this report and with ISO 17025

LC Ref. No. 1289 004 19, Annex C page 1

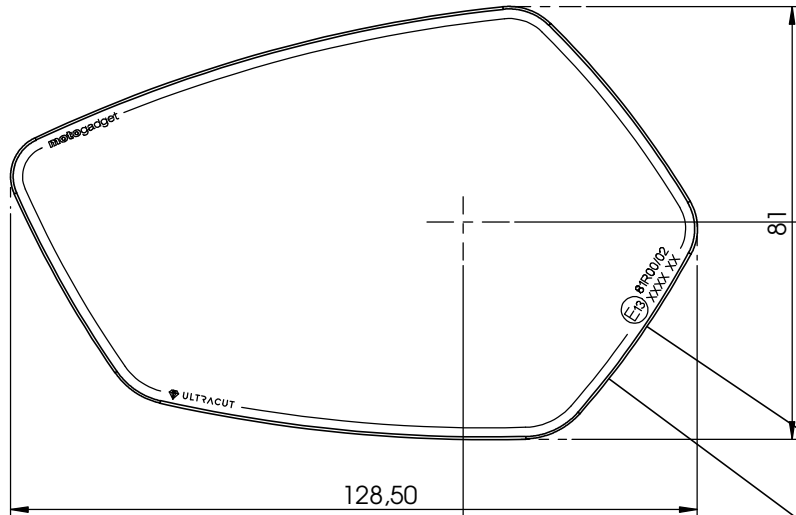

R1450

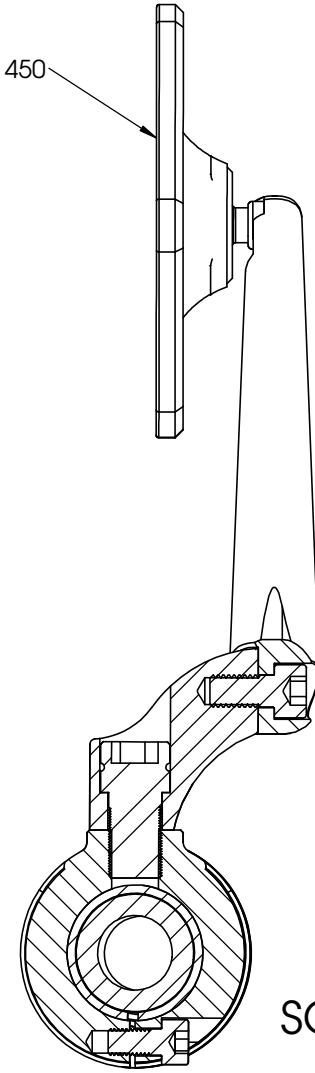

AB

137

121

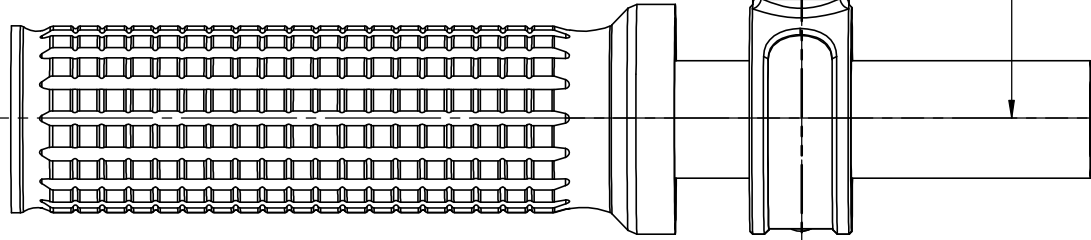

AB

SCHNITT AB-AB  
MAßSTAB 1 : 1

ECE Kennzeichnung durch Lasergravur in Spiegelfläche  
Versionen "links" & "rechts" spiegelsymmetrisch

motogadget GmbH confidential & proprietary

WENN NICHT ANDERS DEFINIERT: BEMASSUNGEN SIND IN MILLIMETER OBERFLÄCHENBESCHAFFENHEIT:		OBERFLÄCHENGÜTE: smooth finish: Rz 4,0 - 10µm black anodized		ENTGRATEN UND SCHARFE KANTEN BRECHEN		ZEICHNUNG NICHT SKALIEREN		ÄNDERUNG	
TOLERANZEN: LINEAR: WINKEL:									
GEZEICHNET	NAME	SIGNATUR	DATUM			BENENNUNG:			
GEPRÜFT	G.Keller	GK	25.07.2016			<b>7002040 (links)</b> <b>7002041 (rechts)</b>			
GENEHMIGT									
PRODUKTION									
QUALITÄT				WERKSTOFF: 6061-T6		ZEICHNUNGSNR. m.view race		A3	
				GEWICHT:		MAßSTAB:5:1		BLATT 1 VON 1	

LC Ref. No. 1289 004 19, Annex C page 2

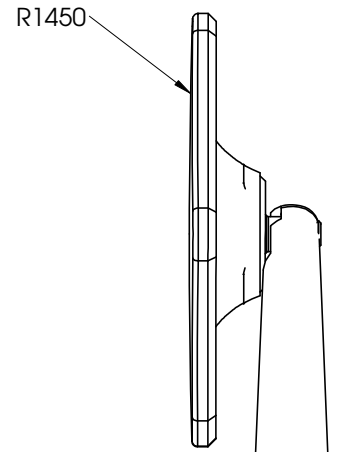
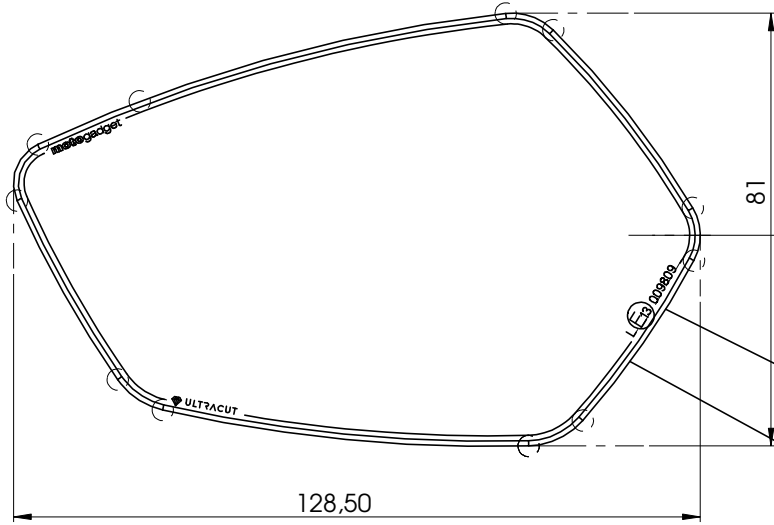

SCHNITT AB-AB  
MABSTAB 1 : 1

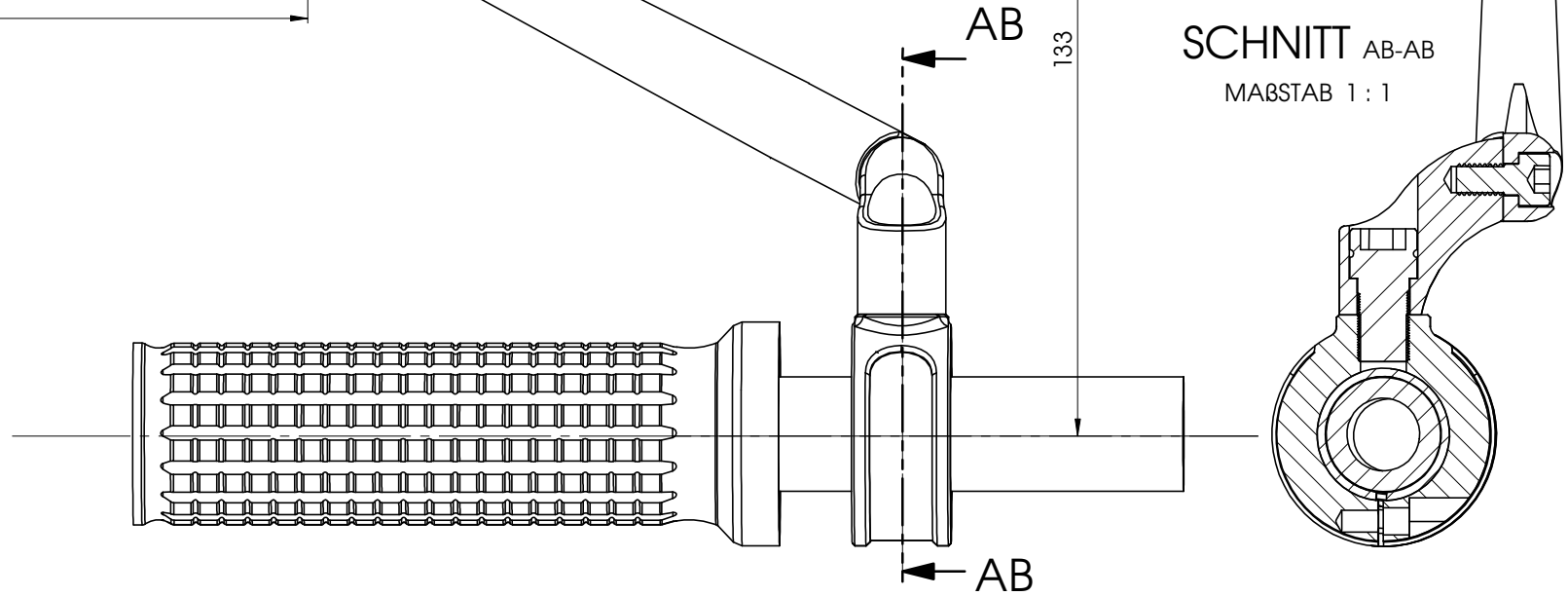

ECE Kennzeichnung durch Lasergravur in Spiegelfläche  
Versionen "links" & "rechts" spiegelsymmetrisch

motogadget GmbH confidential & proprietary

WENN NICHT ANDERS DEFINIERT: BEMASSUNGEN SIND IN MILLIMETER OBERFLÄCHENBESCHAFFENHEIT:				OBERFLÄCHENGÜTE: smooth finish: Rz 4,0 - 10µm black anodized		ENTGRATEN UND SCHARFE KANTEN BRECHEN		ZEICHNUNG NICHT SKALIEREN		ÄNDERUNG	
TOLERANZEN: LINEAR: WINKEL:											
GEZEICHNET		SIGNATUR		DATUM				BENENNUNG:			
G.Keller		GK		25.07.2016				<b>7004040 (links)</b>			
GEPRÜFT								<b>7004041 (rechts)</b>			
GENEHMIGT											
PRODUKTION											
QUALITÄT						WERKSTOFF: 6061-T6		ZEICHNUNGSNR. m.view race XL		A3	
						GEWICHT:		MASSTAB:5:1		BLATT 1 VON 1	