

BMW F750GS '18-

M O U N T I N G I N S T R U C T I O N S

REF 3179

ADJUSTABLE TOURING SCREEN



ID	PIEZA/PART	DESCRIPCIÓN	DESCRIPTION	QTY	REF
1		Cúpula superior	Upper screen	1	3179H/W/FM3
2		Cúpula inferior	Lower screen	1	3179H/W/FM3
3		Soporte metálico derecho (R)	Right metal support (R)	2	SOPOR2P3R--9770
4		Soporte metálico izquierdo (L)	Left metal support (L)	2	SOPOR2P3L--9770
5		Tornillo Allen M5x16 Ø11 ISO 7380	M5x16 Ø11 ISO 7380 Allen screw	8	TORNI-I7380-493
6		Silentblock Ø9 xØ6 x 8mm	Ø9 xØ6 x 8mm silentblock	4	AROPASACABLES-3
7		Casquillo con valona Ø12xØ6,8x7,3	Ø12xØ6,8x7,3 bush with flange	4	CASQUI-1A---750
8		Tapón tornillo M5 ISO 7380	M5 ISO 7380 screw cap	4	TAPON-----85
9		Tapa exterior	Exterior cap	2	CONJU-S3PCC-003
10		Distanciador de nylon Ø22xØ10,4x10mm	Ø22xØ10,4x10mm separator	4	ARAND-----840
11		Arandela cónica de plástico Ø20xØ6x5mm	Ø20xØ6x5mm plastic conical washer	4	ARANDENND20-030
12		Tornillo Ø5x20mm DIN7505A punta F	Ø5x20mm DIN7505A screw (Black)	4	TORNI-D7505-841

BMW F750GS '18-

INSTRUCCIONES DE MONTAJE - MOUNTING INSTRUCTIONS - MONTAGEANLEITUNG

1

DISASSEMBLY
MONTAJE

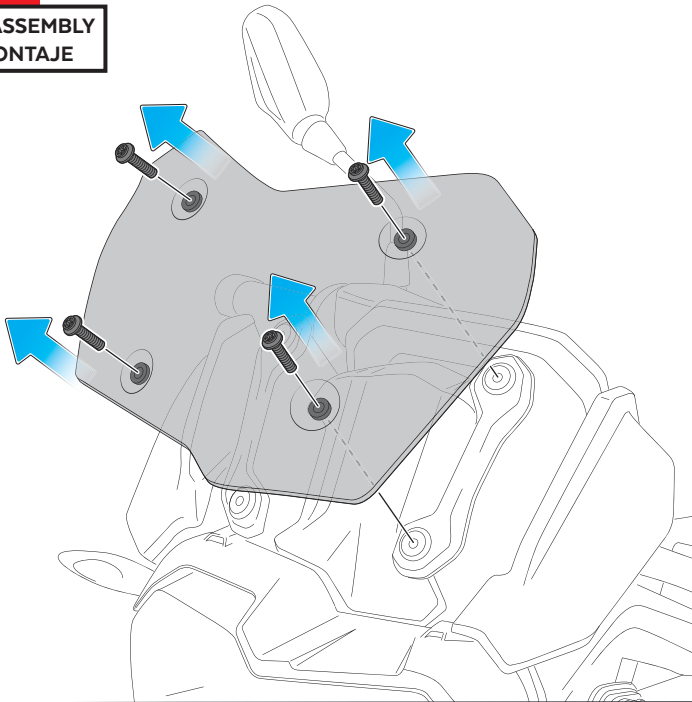

2

ASSEMBLY
MONTAJE

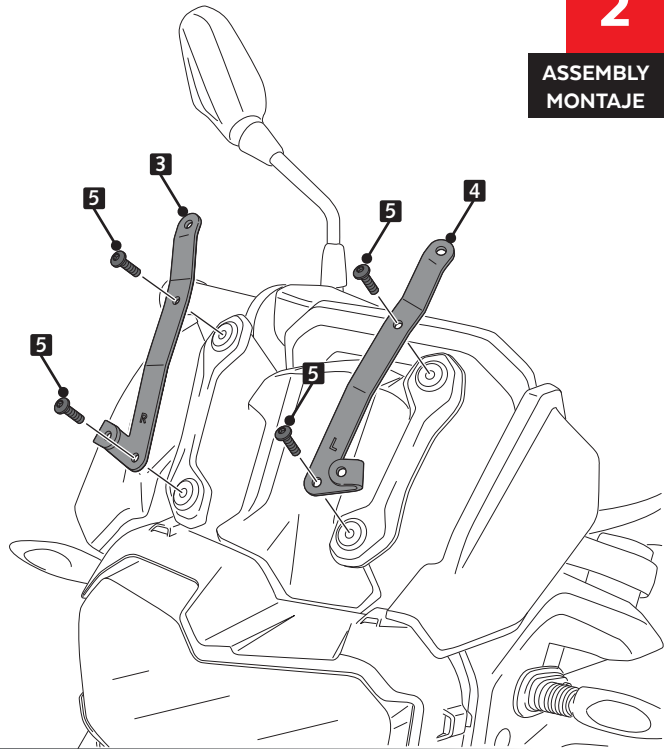

3

ASSEMBLY
MONTAJE

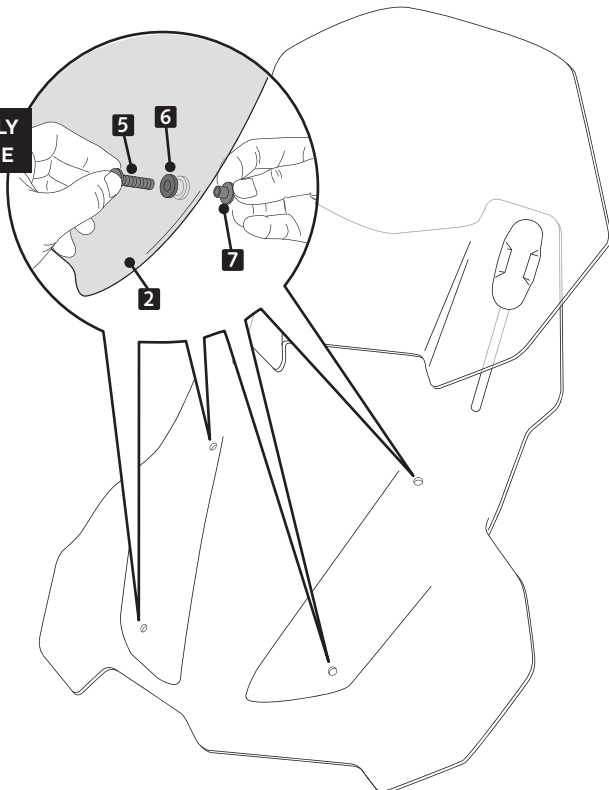

4

ASSEMBLY
MONTAJE

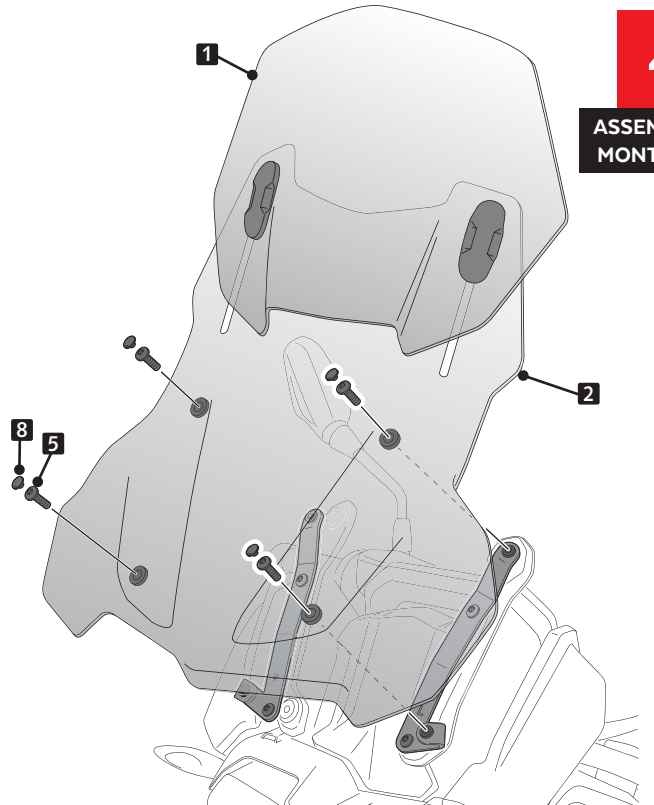

BMW F750GS '18-

EXPLOTING

